

Containers

#	Product Code	Product Description	Liner Bag Type	Solidifying Agent	Flow Stopper	Anti-reflux Valve	Quantity
①	DKI-FF2861	1 Liter Final Liner Bag without solidifying agent	Thick Plastic Type		○		50 pcs /box
②	DKI-FF861	1 Liter Final Liner Bag with solidifying agent	Thick Plastic Type	○	○		50 pcs /box
③	DKI-RD4862P	2 Liter Pre Liner Bag without solidifying agent	Thick Plastic Type				50 pcs /box
④	DKI-RD862P	2 Liter Pre Liner Bag with solidifying agent	Thick Plastic Type	○			50 pcs /box
⑤	DKI-RD4862F	2 Liter Final Liner Bag without solidifying agent	Thick Plastic Type		○		50 pcs /box
⑥	DKI-RD862F	2 Liter Final Liner Bag with solidifying agent	Thick Plastic Type	○	○		50 pcs /box
⑦	DKI-TF4020P	2 Liter Pre Liner Bag without solidifying agent	Film Type			○	50 pcs /box
⑧	DKI-TF3020P	2 Liter Pre Liner Bag with solidifying agent	Film Type	○		○	50 pcs /box
⑨	DKI-TF4020F	2 Liter Final Liner Bag without solidifying agent	Film Type		○	○	50 pcs /box
⑩	DKI-TF3020F	2 Liter Final Liner Bag with solidifying agent	Film Type	○	○	○	50 pcs /box
⑪	DKI-TF4035P	3.5 Liter Pre Liner Bag without solidifying agent	Film Type			○	50 pcs /box
⑫	DKI-TF3035P	3.5 Liter Pre Liner Bag with solidifying agent	Film Type	○		○	50 pcs /box
⑬	DKI-TF4035F	3.5 Liter Final Liner Bag without solidifying agent	Film Type		○	○	50 pcs /box
⑭	DKI-TF3035F	3.5 Liter Final Liner Bag with solidifying agent	Film Type	○	○	○	50 pcs /box

Accessories

#	Product Code	Product Description	Quantity	Product Description
⑮	DKI-FF7301	Canister for 1 Liter	1 pc	Bag Type for 1 Liter
⑯	DKI-RD730P	Canister for 2 Liter Pre	1 pc	Bag Type for 2 Liter Pre
⑰	DKI-RD730F	Canister for 2 Liter Final	1 pc	Bag Type for 2 Liter Final
⑱	DKI-FF7303	Canister for 3.5 Liter Pre/Final	1 pc	Bag Type for 3.5 Liter(Pre・Final)
⑲	DKI-FF707(H)	FF Caster Set for Bag(High)	1 set	Caster(High) + Canister for 2 Liter Pre(3pcs) + Canister for 2 Liter(1pc)
⑳	DKI-FF707(L)	FF Caster Set for Bag(Low)	1 set	Caster(Low) + Canister for 2 Liter Pre(3pcs) + Canister for 2 Liter(1pc)
㉑	DKI-FF708H	FF Caster Set for 3.5 Liter(High)	1 set	Caster(High) + Canister for 3.5 Liter Pre(2pcs)
㉒	DKI-FF704(H)	Caster(High)	1 stand	High for Bag Type
㉓	DKI-FF704(L)	Caster(Low)	1 stand	Low for Bag Type
㉔	DKI-FF704H10	Caster(High) (Disassembled Type)	1 set	10 Disassembled Caster in 1 carton
㉕	DKI-FF765	FF 1 L Wall Hanging Set	1 set	Canister for 1 Litter + Hook for Canister
㉖	DKI-FF767	FF 2 L Wall Hanging Set	1 set	Canister for 2 Litter + Hook for Canister
㉗	DKI-RD792	Wall Hanging Hook for Canister	1 pc	Wall Hanging
㉘	RG-300	FitFix Regulator	1 pc	*Trestle is required to be installed
㉙	DKI-FF704K	Trestle for Regulator	1 pc	Trestlet for Regulator
㉚	DKI-RD886	Three way stopcock	1 pc	Suction way switch valve
㉛	DKI-RD890	Nipple with bowl valve	1 pc	Switch valve
㉜	DKI-RD795	Caster Hook for Canister	1 pc	Caster Hook

Expendables

#	Product Code	Product Description	Quantity	Product Description
㉝	DKI-RD920	Solidifying agent bottle	30 bottles	1 bottle: 220g
㉞	DKI-RD888	Inlet elbow	120 pcs	White
㉟	DKI-RD841	Flow stopper	30 pcs	Overflow Protection



\*For ICU & NICU

How to set-up &  
How to use  
video available



[https://www.daiken-iki.co.jp/en/pi/seihin\\_ff.html](https://www.daiken-iki.co.jp/en/pi/seihin_ff.html)



Pioneering the future of medical technology  
**DAIKEN MEDICAL CO., LTD.**

International Department: 2-6-2, Ayumino, Izumi-city,  
Osaka, 594-1157, Japan

COOPDECH's product information is available at the corporate website.  
<https://www.daiken-iki.co.jp/en/>

2025.4

Contents of this catalog are as of April 2025.  
(2504C)



COOPDECH

COOPDECH FitFix™  
(Disposable Suction Container System)

- Strong and consistent suction system
- Safe handling of medical waste by using solidifying agent
- Available with or without solidifying agent
- Easy to handle
- Compact footprint
- Variety of configurations

The contents of this catalog do not reflect the registration status of any particular country.  
In order to sell, registration in the sales country is required.

 **DAIKEN MEDICAL CO., LTD.**





# Disposable Suction Bag FitFix™

## Infection Control with Safety New Standard for Medical Suctioning Device

### “FitFix” SUCTION CONTAINER SYSTEM

The safest & the most widely used medical disposable suction system in Japan.

- Daiken Medical offers a complete set of fluid management products to provide everything you need. Our single-use systems deliver exceptional performance and provide hygienic, safe and efficient disposal of liquid waste.
- Completely closed system and the solidifying agent integrated on top of the liner bag, allows healthcare workers to handle the biological liquid waste without exposure.
- An anti-flux valve and hydrophobic shut-off filter perform the function of overflow valve, by stopping the suction when the maximum level of filling has been reached.
- A graduated scale, printed on the external canister, allow the monitoring of the volume of collected fluid.



Single Wall-mounted Type

#### Liner Bag 1.0 L Thick Plastic Type

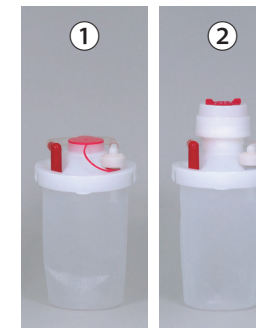

①DKI-FF2861 ②DKI-FF861

#### Liner Bag 2.0 L Thick Plastic Type



③DKI-RD4862P ④DKI-RD862P

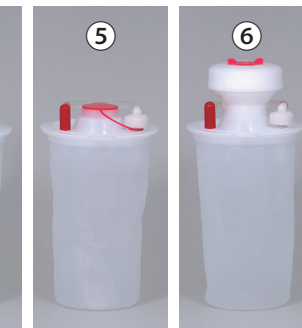

⑤DKI-RD4862F ⑥DKI-RD862F

#### Liner Bag 2.0 L Film Type

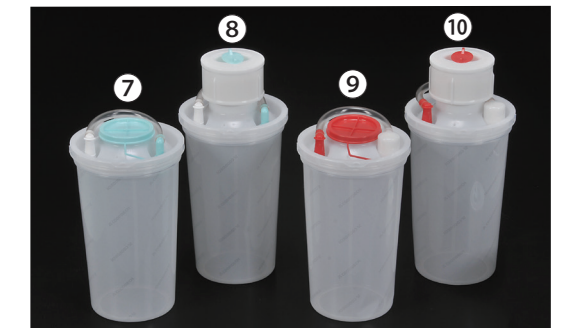

⑦DKI-TF4020P ⑧DKI-TF3020P  
⑨DKI-TF4020F ⑩DKI-TF3020F

#### Liner Bag 3.5 L Film Type

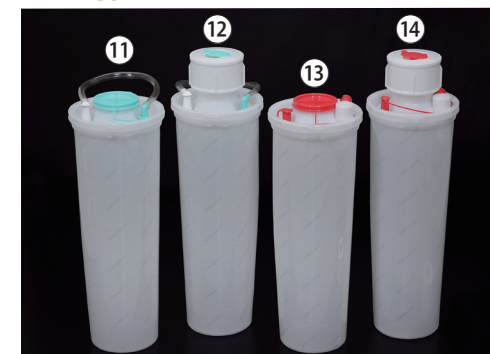

⑪DKI-TF4035P ⑫DKI-TF3035P  
⑬DKI-TF4035F ⑭DKI-TF3035F

#### Canister

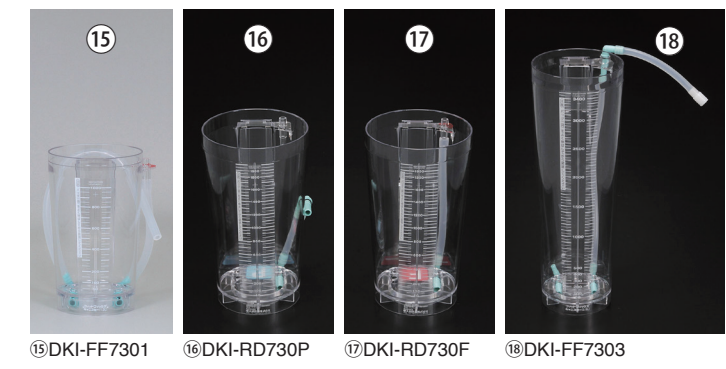

⑮DKI-FF7301 ⑯DKI-RD730P ⑰DKI-RD730F ⑱DKI-FF7303

#### Caster Set

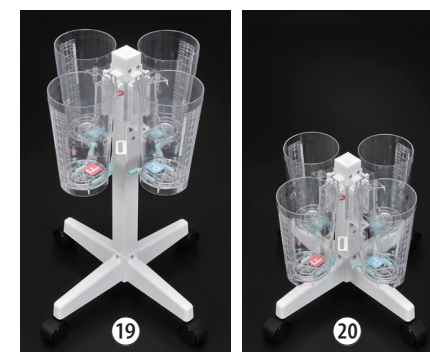

⑲DKI-FF707(H) ⑳DKI-FF707(L)



㉑DKI-FF708H

#### Caster



㉒DKI-FF704(H)



㉓DKI-FF704(L)

#### Disassembled Type



㉔DKI-FF704H10

#### Wall Hanging Set



㉕DKI-FF765 ㉖DKI-FF767 ㉗DKI-RD792

#### Others

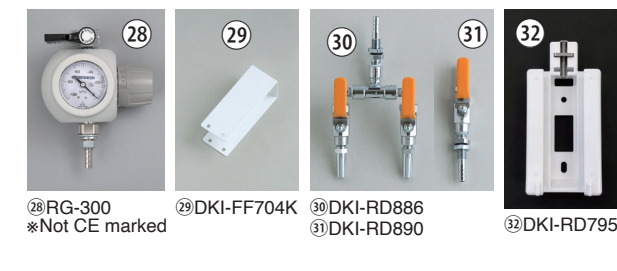

㉘RG-300  
\*Not CE marked ㉙DKI-FF704K ㉚DKI-RD886  
㉛DKI-RD890 ㉜DKI-RD795

#### Expendables

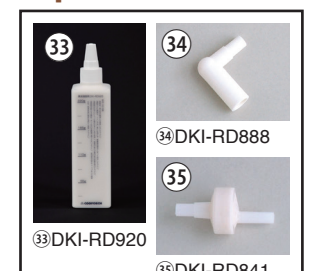

㉝DKI-RD920 ㉞DKI-RD888  
㉟DKI-RD841

### Procedures:

#### Setting up the Liner Bag



Pull up the liner bag.



Set each liner bag firmly to the canisters. For the Pre liner bags, connect the vacuum tube set to the patient port seated next to each liner. For Final liner bag, connect the inlet elbow to its connector.



Attach the connecting tube to the patient port on the FitFix Liner pre#1 and start suctioning.

#### Detaching the Liner Bag



After suctioning, connect the inlet port to its own Inlet and seal it firmly.



Disperse the solidifying agent by rotating the plunger 90 degrees, then push it downwards.



After confirming the suction fluid is solidified, remove the liner bag from the canister.